

Lyra Streaming Combo

Quick Guide

V1.0.0

Foreword

Thank you for purchasing the Hollyland Lyra 4K UHD webcam. Please read this user manual carefully before using the product.

EN Please read this Quick Guide carefully. We wish you a pleasant experience. To obtain Quick Guide information in other languages, please scan the QR code below.



Packing List

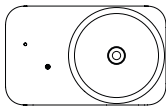

Lyra × 1

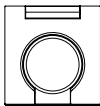

Magnetic Base × 1

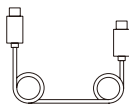

1.5m USB-C to USB-C
Cable × 1



Transmitter × 1



Magnet × 1



Charging Dock × 1

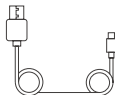

USB-A to USB-C
Cable × 1



USB-C to USB-A
Adapter × 1



Furry
Windshield × 1

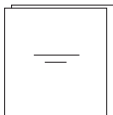

Quick Guide & Compliance
Information × 1

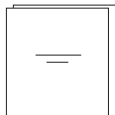

Warranty Card & Packing
List Card × 1

Note: The quantity of included items may vary based on the purchased configuration. Please refer to the actual product package for details.

Product Overview

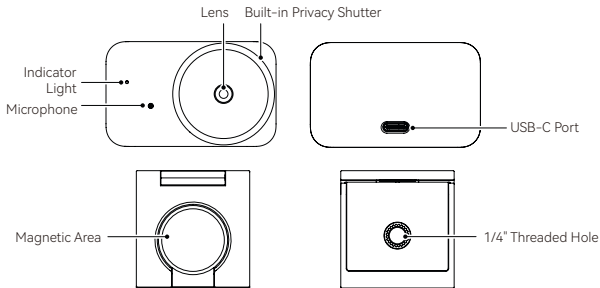

Indicator Light

Device Status	Indicator Status
Device initializing	Flashing blue
Ready to use	Solid blue
Device in use	Solid green
Firmware updating	Flashing pink
Device malfunction	Solid red
Paired with wireless microphone	Flashing green

Setting Up

■ Mounting Instruction

Lyra supports multiple placement methods. It can be clipped onto a monitor using the magnetic base or mounted on a tripod via the 1/4" threaded hole at the bottom of the magnetic base.

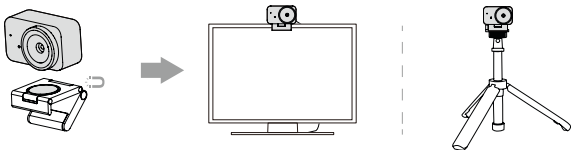

■ Connect to the Computer

Connect Lyra to the computer using the included USB-C to USB-C cable and the USB-C to USB-A adapter. Once connected, the indicator light stays on, and the device is ready to use.

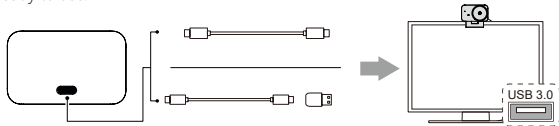

Note:

- To prevent the product from malfunctioning due to insufficient power supply, please connect it directly to your computer or use a docking station with an independent power supply. The computer USB port and docking station should support USB 3.0.
- Lyra is compatible with computers running Windows and macOS systems. To avoid compatibility issues, be sure to use the included cable to connect to the computer.

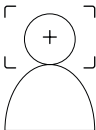
■ Auto-Framing

Lyra supports face recognition tracking. It can lock onto a person in the frame during all tracking movements and automatically complete the composition by adjusting the frame position and proportion.

■ Privacy Protection

You can block the webcam by rotating the privacy shutter for enhanced personal privacy.

■ LARK A1 Transmitter

1. Wearing Method

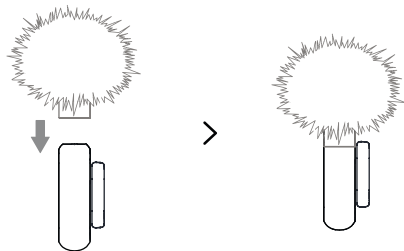
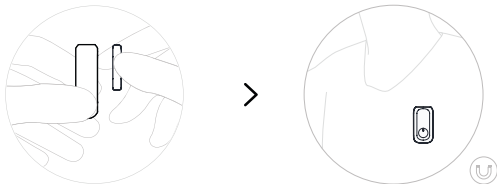

2. LED Status & TX Control

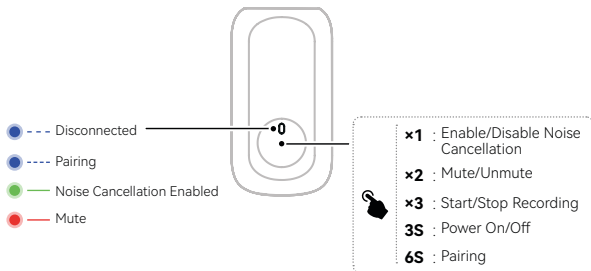

3. TX Battery LED Status

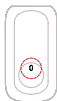

Non-Charging

- Red dashed line: 0%-6%
- Green solid line / Blue solid line: 7%-100%

Charging

- Orange solid line: 0% - 94%
- Green solid line: 95% - 100%

4. How to Charge

After connecting the charging dock and the USB-A to USB-C cable, you can charge the LARK A1 transmitter.

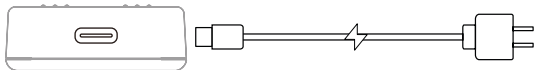

■ Connect LARK A1 TX with Lyra

1. Download our Hollyland CAM software to your computer from <https://www.hollyland.com/download>.
2. Open the Hollyland CAM software on your computer.
3. Click Audio Settings in Settings. When the LARK A1 is off, press and hold the button for 6 seconds to enter pairing mode. When the LARK A1's blue light flashes rapidly, click Start Pairing.
4. A solid blue light on the LARK A1 indicates successful pairing.

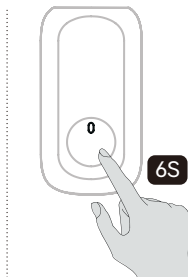
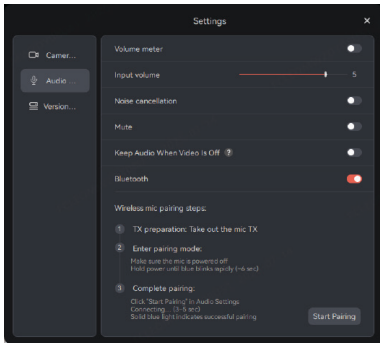

Specifications

Lyra

CMOS	1/1.5"
Digital Zoom	1-4x
Input Power	5V === 1A
Operating Temperature	0°C~45°C

LARK A1 TX

Mic Sensitivity	-37dBV±2dBV@1KHz, 94dBSPL
Wireless Modulation Mode	GFSK 2Mbps
Wireless Transmission	2.4 GHz Adaptive Frequency Hopping (AFH)
Transmission Range	10m
Mic Polar Pattern	Omnidirectional
Frequency Response	20Hz~20KHz
Signal-to-Noise Ratio	≥ 67dB
Max Sound Pressure Level	120dB SPL
Sample Rate and Bit Depth	48kHz/24Bit
Battery Voltage	3.8V
Battery Capacity	65mAh
Charging Time	< 1.5H

Warning

If you fail to take the following precautions, you may be seriously injured or killed by the electric shock or fire disaster caused, or your webcam may be damaged. Please check whether the webcam and accessories are intact before using them. For security reasons, only Hollyland accessories that are provided with the webcam or genuine ones purchased can be used. The use of any other parts, accessories, or chargers not recommended by Hollyland may cause fire disaster, electric shock, or personal injury. Damage caused by the use of unauthorized accessories is not covered by the warranty. For approved accessories, please visit the Hollyland official website at <https://www.hollyland.com>.

1. Do not touch the USB cable ports with wet hands when connecting the webcam to the computer. Failure to follow this precaution may cause electric shock.
2. Do not place or secure the webcam on an unstable surface. Failure to follow this precaution may cause the webcam to loosen or fall, potentially leading to an accident or damage.
3. If using a third-party USB data cable for connection, comply with all safety guidelines provided by the third-party manufacturer.
4. The lens of the webcam is made of glass. If the lens is damaged, please handle it carefully to avoid being scratched by the broken lens/glass and keep it away from children.
5. If the webcam operates continuously for an extended period, the body may become slightly warm, which is a normal phenomenon.

6. This product is not a toy and you are solely responsible for complying with all local laws, regulations, and restrictions.
7. Do not use the webcam for unauthorized monitoring, candid shooting, or in any way that violates personal privacy regulations. Normally, it is strictly forbidden to use the webcam for such purposes. If you fail to follow this precaution, you may bear huge responsibilities and face criminal proceedings.
8. Do not put the webcam in extremely cold or hot environments. Extremely cold or hot environments may cause the webcam to temporarily stop working properly.

Note:

There is no protection for the lens of the webcam. If you do not pay attention to it, it is easy to cause scratches. Please avoid placing the lens of the webcam on any surface. Lens scratches are not covered by the warranty.

Disclaimer

1. Please read and follow all the instructions carefully.
2. Please note all the warnings.
3. Do not use the product near heat sources such as radiators, electric heaters, stoves, or other heat-producing equipment.
4. Use only parts and accessories specified or provided by Hollyland.
5. Please hand over all maintenance work to qualified personnel. No matter what kind of damage the product suffers, such as damage to the power cable or plug, liquid penetration, objects falling into the product, rain, dampness, failure to work normally, or falling, maintenance is required.

Support

If you encounter any problems in using the product or need any help, please contact Hollyland Support Team via the following ways:



Hollyland User Group



HollylandTech



HollylandTech



HollylandTech



support@hollyland.com



www.hollyland.com

Statement:

All copyrights belong to Shenzhen Hollyland Technology Co., Ltd. Without the written approval of Shenzhen Hollyland Technology Co., Ltd., no organization or individual may copy or reproduce part or all of any written or illustrative content and disseminate it in any form.

Trademark Statement:

All the trademarks are owned by Shenzhen Hollyland Technology Co., Ltd.

Note:

Due to product version upgrades or other reasons, this Quick Guide will be updated from time to time. Unless otherwise agreed, this document is provided as a guide for use only. All representations, information, and recommendations in this document do not constitute warranties of any kind, express or implied.

HOLLYVIEW

Powered by Hollyland

Manufacturer: Shenzhen Hollyland Technology Co., Ltd.

Address: 8F, 5D Building, Skyworth Innovation Valley, Tangtou
Road, Shiyan Street, Baoan District, Shenzhen, 518108, China

MADE IN CHINA